

# INSTALLATION STEPS

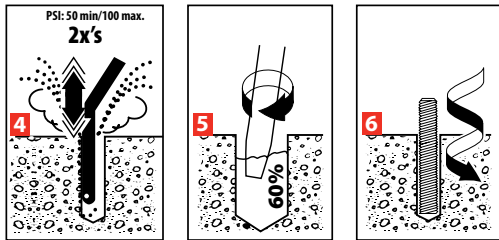
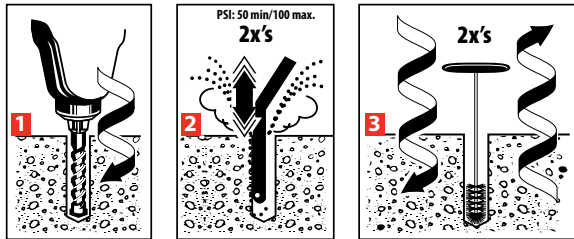

1. Use a rotary hammer drill or pneumatic air drill with a carbide drill bit complying with ANSI B212.15. Drill hole to the required embedment depth. For installation of 3/8" – 1-1/4" anchors, see [www.itwredhead.com](http://www.itwredhead.com) for a bit diameters and min/max embedment depths.
2. Starting at the bottom of the hole, move a clean air nozzle in and out of the hole, cleaning with compressed air. Repeat until free of debris.\*\*
3. Select appropriately sized Red Head brush based on anchor diameter and depth of hole. See [www.itwredhead.com](http://www.itwredhead.com) for brush specifications, including minimum diameter. Check brush for wear before use. Insert the brush into the hole with a clockwise motion until the bottom of hole is reached. Pull brush out of hole and repeat at least one additional time. For faster cleaning, attach the brush to a drill/drive.
4. Repeat Step 2
5. Place the cartridge/nozzle assembly into the dispensing tool. Note: Do not modify or remove mixing elements in nozzle. Review the gel time/cure time chart, based on the temperature at time of installation, in order to determine tool, cartridge and nozzle requirements. Dispense mixed adhesive outside of hole until uniform color is achieved. Insert the nozzle to the bottom of the hole and dispense adhesive until hole is 2/3 full. If nozzle does not reach the bottom of the hole, use Red Head extension tubing positioned on the end of the nozzle. For holes that contain water, keep dispensing adhesive below water in order to displace the water upward.
6. Immediately insert the rod/rebar assembly to the required embedment depth using a slow rotating motion. The anchor rod/rebar must be marked with the required embedment depth. Ensure the adhesive fills all voids and uniformly covers rod/concrete. Do not disturb anchor or apply load/torque until adhesive is fully cured.